

LINDHAUS

LINDWASH 30-38

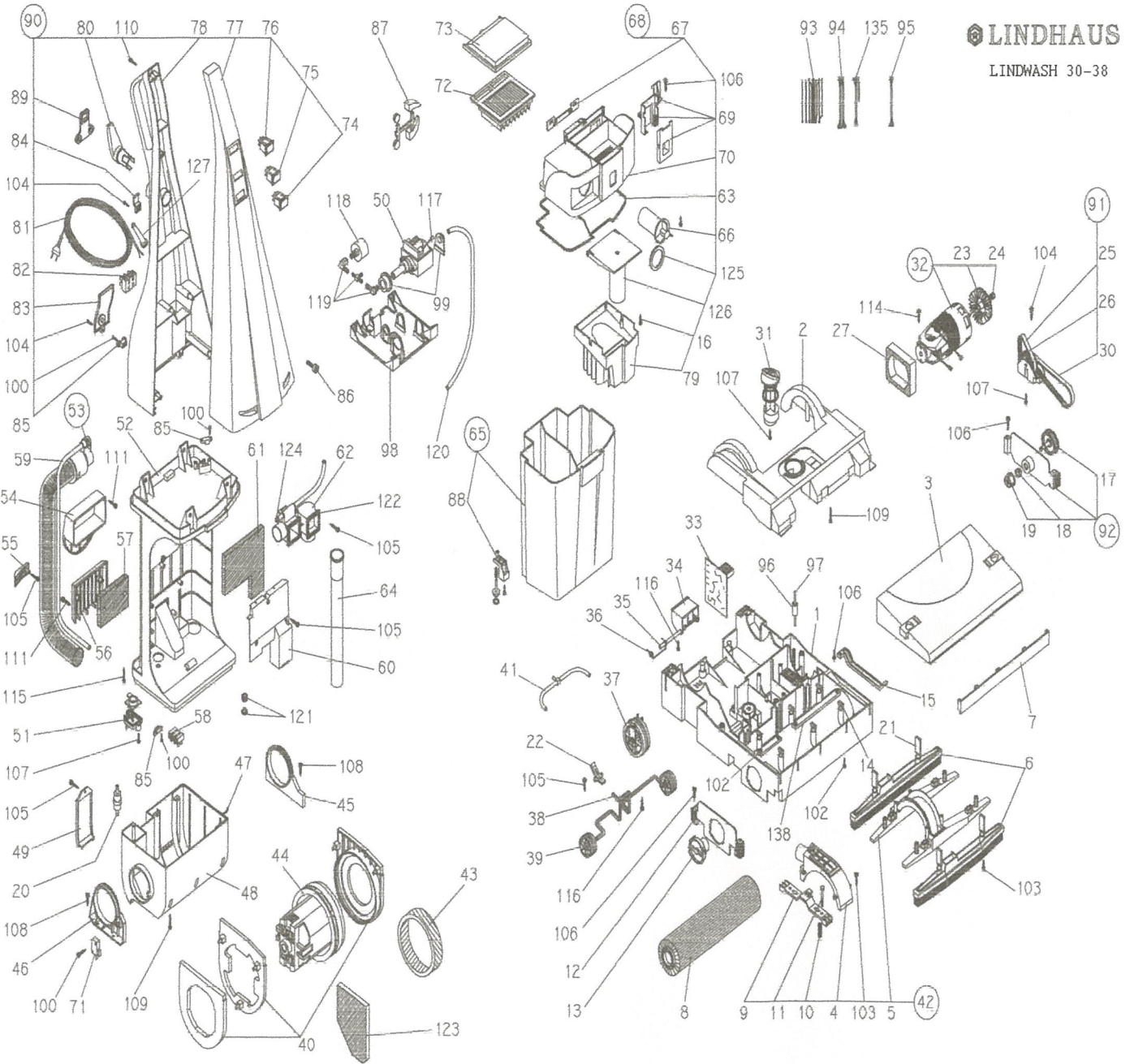

26	,086430081	DOUBLE PULLEY WITH BEARINGS
27	,010580016	FILTER, BRUSH MOTOR
30	,013450300	TIMING BELT 8mm L.327
31	,006830104	ADJUSTING HEIGHT KNOB
32_	,051190080	BRUSH MOTOR 120/60
32A_	021260000	CARBON BRUSH FOR BRUSH MOTOR R73 (SET OF TWO)
33	,023240000	CIRCUIT BOARD V.120
34	,006840104	FOOT PEDAL
35	,013470009	SHAFT, FOOT PEDAL
36	,013480009	SPRING, FOOT PEDAL
37	085490081	REAR WHEEL ASSEMBLY
38	,013290009	SHAFT, FRONT WHEEL
39	002260000	FRONT WHEEL RUBBER
40	,088320381	GASKET KIT, VACUUM MOTOR (3 PCS)
41	,088500000	BASE TUBE KIT (1 PC)
42_	,088330081	CONVEYOR NOZZLE KIT 30 (12") (1 PC)
42_	,088340081	CONVEYOR NOZZLE KIT 38 (14") (1 PC)
43	,013540316	FILTER, VACUUM MOTOR
44	,087850080	VACUUM MOTOR V.120 WITH GASKETS [CONTAINS #40]
45	,006950404	MOTOR HOUSING SUPPORT LEFT
46	,006940404	MOTOR HOUSING SUPPORT RIGHT
47	,088510000	GASKET, MOTOR HOUSING
48	,006261233	MOTOR HOUSING
49	,006961204	MOTOR HOUSING COVER
50	,023290000	PUMP V.120/60
51_	,087860081	VALVE KIT (4 PCS)
51A_	,013690037	FILTER BLUE (ONLY)
52	,088351201	UPPER HOUSING
53	,088520081	HOSE, SUCTION ASSEMBLY
54	,007010101	TRANSPORT HANDLE
55	,007021204	HOSE HOOK
56	,007031204	GRILL, EXHAUST FILTER
57	,013550316	EXHAUST FILTER
58_	,022850400	TERMINAL BLOCK 16A 3 POSITION
58_	,023090400	TERMINAL BLOCK 15A 4 POSITION
59	,088530000	TUBE D.4 L.730mm
60	,007051204	AIR CONVEYOR
61	,013560316	FILTER, AIR CONVEYOR
62	,088360381	CONVEYOR AIR / WATER
63	,013570315	GASKET, FILTER HOUSING
64	,088370381	INTERNAL TUBE WITH GASKET
65	,087884181	WATER TANK [CONTAINS #88]
66	,007083101	DOSING CUP
67	,007091201	LATCH, FILTER HOUSING REAR
68	,088384181	FILTER HOUSING COMPLETE
69	,088140181	LATCH KIT, FILTER HOUSING FRONT
70	,006934101	FILTER HOUSING
71	,023520000	MICROSWITCH
72	,013580000	FILTER, WATER TANK (WASHABLE)
73	,007103101	FILTER COVER
74	,023460000	MAIN SWITCH
75	,023470000	VACUUM SWITCH
76	,023450000	PUMP SWITCH
77	,006880201	FRONT HANDLE GREY
78	,006891233	REAR HANDLE GREY
79	,007773101	ANTI-SPLASH
80	,007110101	ROTATING CORD HOOK
81	022480020	CORD 3x18 12,5 MT. USA PLUG YELLOW (3 PRONG / 41 FT)
82_	,021680400	TERMINAL BLOCK 16A 2 POSITION
82_	,022850400	TERMINAL BLOCK 16A 3 POSITION
83	,006901201	TERMINAL BLOCK COVER

84	,001690110	UPPER CORD HOOK
85	,000070305	CORD CLAMP
86	,088390009A	SCREW M6x20 (SINGLE)
87	,006910112	RUBBER CUP KIT (4 PCS)
88	,087870081	VALVE KIT, WATER TANK (1 PC)
89	,006040308	STRAIN RELIEF, UPPER, ANTI-TEARING CORD SAFETY GUARD
90	,088420280	ELECTRIC PANEL V.120/60
91	,087890081	CENTRAL TRANSMISSION SUPPORT WITH BELTS
92	,087900081	TRANSMISSION SUPPORT COMPLETE
93	,089020028	ELECTRIC PANEL WIRE KIT V.120/60
94	,023130320	UPPER HOUSING WIRE KIT V.120/60
95	,023650320	BASE HOUSING WIRE KIT V.120/60
96	,006050104	SIDE WHEEL
97	,013490009	SHAFT, SIDE WHEEL
98	,007420304	PUMP HOLDER
99	,088430308	RUBBER SUPPORT, PUMP
100	085610009A	SCREW 2.9x16 (SINGLE)
102	085540009A	SCREW 3.5x9.5 TG (SINGLE)
103	,088440009A	SCREW 3.5x13 1X (SINGLE)
104	085560009A	SCREW 3.9x16 (SINGLE)
105	,088020009A	SCREW 3.5x13 (SINGLE)
106	,088450009A	SCREW 3.5x16 1X (SINGLE)
107	086450009A	SCREW 3.9x13 TG (SINGLE)
108	085550009A	SCREW 3.5x25 (SINGLE)
109	,087250009A	SCREW 3.5x22 (SINGLE)
110	085570009A	SCREW 3.5x32 (SINGLE)
111	,087260009A	SCREW 3.9x22 (SINGLE)
114	085580009A	SCREW 3.9x19 (SINGLE)
115	,087740009A	SCREW 3.9x45 (SINGLE)
116	,088460009A	SCREW 4.8x13 TG 1X (SINGLE)
117	,023500028	CORD WITH THERMAL PROTECTOR, PUMP
118	,023380028	ELECTRIC PRESSURE SWITCH
119	,088470000	CONNECTION TUBE KIT (1 PC)
120	,088570000	TUBE D.4 L.760mm
121_	,089180081	WATER FILTER PUMP KIT (3 PCS) [CONTAINS #20] [NOT AS SHOWN ON DIAGRAM]
121A_	,013690037	FILTER BLUE (ONLY)
122	,088490000	GASKET CONVEYOR N.2 (2 PCS)
123	,013590316	FILTER, MOTOR
124	,088560000A	O-RING (SINGLE)
125	,013520315	GASKET, DOSING CUP
126	,088930381	TRIMMER
127	,010830307	STRAIN RELIEF, CORD 100/120V
135	,023640028	MOTOR HOUSING WIRE KIT 120V
138_	,007403101	SHORT (LW30 / 12") COVER PIPE KIT (2 PCS)
138_	,007413101	LONG (LW38 / 14") COVER PIPE KIT (2 PCS)
	_088160081	UPHOLSTERY KIT (2 PCS) (LW30 / LW38)
	_032090000	WINDOW CLEANING KIT (LW30 / LW38) [REQUIRES HOSE FROM UPHOLSTERY KIT]

CONCENTRATED FLOOR CLEANING SOLUTION DESIGNED FOR LINDWASH FLOOR SCRUBBERS

CHE-7500	PURE POWER / NEUTROLUX - 12 QUARTS (ALL PURPOSE FLOOR CLEANER)
CHE-6000	PURE POWER / POWER SCRUB - 12 QUARTS (COMMERCIAL FLOOR CLEANER)
CHE-6100	PURE POWER / POWER SCRUB - 4 GALLONS (COMMERCIAL FLOOR CLEANER)

ENCAPSULATION IS LOW MOISTURE CARPET CLEANING METHOD / USE MACHINE WITH CARPET NOZZLE [#6]

CHE-7000	PURE POWER / OXY-GEN - 12 QUARTS (ENCAPSULATION CARPET CLEANER)
----------	---