

CH pro eco FORCE USA

LINDHAUS
 QUALITY CLEANING EQUIPMENT



VIA BELGIO, 22 Z.I. - 35127 PADOVA - ITALY

Ph. +39 049 8700307 - Fax +39 049 8700605

e-mail: vacuum@lindhaus.it - www.lindhaus.it

Cod.Fiscale - P.IVA - Reg.Imp.PD 02151740285

Capitale Sociale 46.800,00 i.v.

LINDHAUS U.S.A.

P.O. BOX 159 / 12941 EAGLE CREEK PARKWAY
SAVAGE, MN 55378

www.lindhaususa.com

www.lindhaus.net

info@lindhaus.com

1-800-498-7526 / 952-707-1131

FAX: 952-707-1134

PARTS LIST

EFFECTIVE FROM

DATE

PAGE

1/2

CH PRO ECO FORCE - BODY

MODEL: 031208 (CHPRO 12") / 031408 (CHPRO 14")

Pos	Part Number	Description
1	080174681	BAG HOUSING COVER GREY
3	100093001	GRILL FILTER HOLDER RED
4	084580081	SAFETY SUPPORT KIT (4 PCS)
5_	015230316	INTERNAL FILTER
5_	,087170081	CARBON ACTIVE FILTERS (5 PACK)
6	084370081	BAG ENTRANCE WITH SAFETY SUPPORT
7	084520081	BUTTON+SUPPORT+SPRING 2 POSITION
8_	031740310	ROUND DUSTING BRUSH WITH NATURAL BRISTLES (D.38mm 1-1/2") [STANDARD]
8_	,031110300	UPHOLSTERY TOOL WITH NATURAL BRISTLE [COMPLETE] (D.38mm 1-1/2")
8A_	,030900300	UPHOLSTERY TOOL, NATURAL BRISTLE BRUSH [ONLY]
8_	,030820300	UPHOLSTERY TOOL WITH CENTER STRIP [COMPLETE] (D.38mm 1-1/2")
8B_	,030740300	UPHOLSTERY TOOL, BLACK CENTER STRIP BRUSH [ONLY]
9	001830105	ROUND DUSTING BRUSH SUPPORT
10	182024681	BAG HOUSING COMPLETE
11	080790081	VALVE KIT (2 PCS)
12	011050016	VALVE FILTER
13	010260307	O-RING
14_	181460381	EXTENSION HOSE WITH HANDLE GRIP ECO FORCE (D.38mm 1-1/2") [STANDARD]
14A_	183380381	HANDLE GRIP KIT FOR EXTENSION HOSE ECO FORCE (D.38mm 1-1/2") (3 PCS)
14_	,030860300	EXTENSION HOSE 3-1 WITH SLEEVES (CUFF TO CUFF) (D.38mm 1-1/2")
14B_	,030040310	HOSE SLEEVE (CUFF) FOR EXTENSION HOSE (D.38mm 1-1/2")
15	002730104	WAND / CREVICE TOOL CLIP
16	,001950110	UPPER HOSE HOOK
17	,080773881	HANDLE GRIP (ONLY) BLUE
18	,002870105	RETAINER
19	084590081	CHROMATE TUBE - 2 POSITION WITH BUTTON LOCK
21	,084413881	HANDLE TUBE ASSEMBLY 2 POSITION
22	,083494680	ELECTRIC SYSTEM ASSEMBLY, 3 WAY SWITCH
23	022480020	CORD 3x18 12.5 MT. USA PLUG YELLOW (3 PRONG / 41 FT)
24	010830307	STRAIN RELIEF V.100/120 D.8
25	000070305	CORD CLAMP
26	,021340000	VACUUM SENSOR
28	,021050300	MAIN SWITCH 15A 3 WAY
29	,020020000	INDICATOR LIGHT
31	,001883805	LOWER CORD HOOK BLUE

32	,002034601	HANDLE COVER WITHOUT ELECTRONIC
34	,001980306	COMB WIRE HOLDER
35	,001904601	FRAME HANDLE GREY
36	010200016	FILTER, FOAM UPPER
37	000200308	GASKET
38	,020790400	TERMINAL BLOCK 4 POLES
39	011790016	FOAM MOTOR FILTER
40	007940308	MOTOR GASKET
41	082723881	BAG DOOR LATCH + SPRING BLUE
42_	085350081	EXHAUST MICROFILTER (12 PACK) [HF6/VAL/HCP/RX/CHP/ACT/DYN/DIA/LB4]
42_	030640000	HEPA FILTER
42_	,030650000	CARBON ACTIVE EXHAUST FILTER
43	003360100	EXHAUST GRILL
45	,083634681	FRONT GRILL [INCLUDES #64 BOTTOM COVER KIT]
46	003980133	BLOCKING JOINT PIN SUPPORT
47	010840009	JOINT PIN
48	001503805	CONTROL PIN SLIDE BLUE
49	003964644	VACUUM MOTOR HOUSING
50	001760331	LOWER CURVE
51	084610080	CURVE SUPPORT V.120/60 3 WIRES
52	001750331	UPPER CURVE
53	010270307	O RING
54	,084624681	INNER VACUUM MOTOR HOUSING
55	003970133	HOSE INLET
56	180840080	CORD CLAMP WITHOUT ELECTRONIC 4 WIRES ECO FORCE
57_	051350080	VACUUM MOTOR R26APSS (HE) V.120/60 W.750
57A_	022290000	CARBON BRUSH R26 (CERAMIC) (SET OF TWO)
57B_	,022200000	THERMAL PROTECTOR
58	010220016	FILTER, FOAM MOTOR
59	030060310	CREVICE TOOL (D.38mm 1-1/2")
60	032350300	TELESCOPIC WAND ECO FORCE (D.38mm 1-1/2")
61	009180003	4 CONTACT HOUSING COVER
62	009190003	4 CONTACT HOUSING
63	,003230001	VACUUM SENSOR ADAPTOR
64	,084443881	BOTTON COVER KIT BLUE (1 PC)
66	180680009A	SCREW 3.5x57 (SINGLE)
67	,005203801	BUTTON BLUE ECO FORCE
68	012980009	HANDLE SPRING
69	085550009A	SCREW 3.5x25 (SINGLE)
70	086440009A	SCREW 3.5x19 (SINGLE)
71	085590009A	SCREW 3.9x13 (SINGLE)
72	087260009A	SCREW 3.9x22 (SINGLE)
73	087050009A	SCREW 3.5x16 (SINGLE)
74	085560009A	SCREW 3.9x16 (SINGLE)
75	087250009A	SCREW 3.5x22 (SINGLE)
76	085610009A	SCREW 2.9x16 (SINGLE)
77	088020009A	SCREW 3.5x13 (SINGLE)
78	180670009A	WASHER D.4 (SINGLE)
	,030610019	PH4 BAGS (10 BAGS + 2 MICROFILTERS)
	,083540100	BLOWER PORT [ACCESSORY TO CONVERT INTO BLOWER]
	_082924681	HARD FLOOR TOOL M28F (D.38mm 1-1/2") [COMPLETE]
	_080070081	HOSE CRUSHPROOF 5 FT (D.38mm 1-1/2")
	_086700081	HOSE CRUSHPROOF 9 FT (D.38mm 1-1/2")
	_030850310	EXTENSION TUBE (D.38mm 1-1/2")

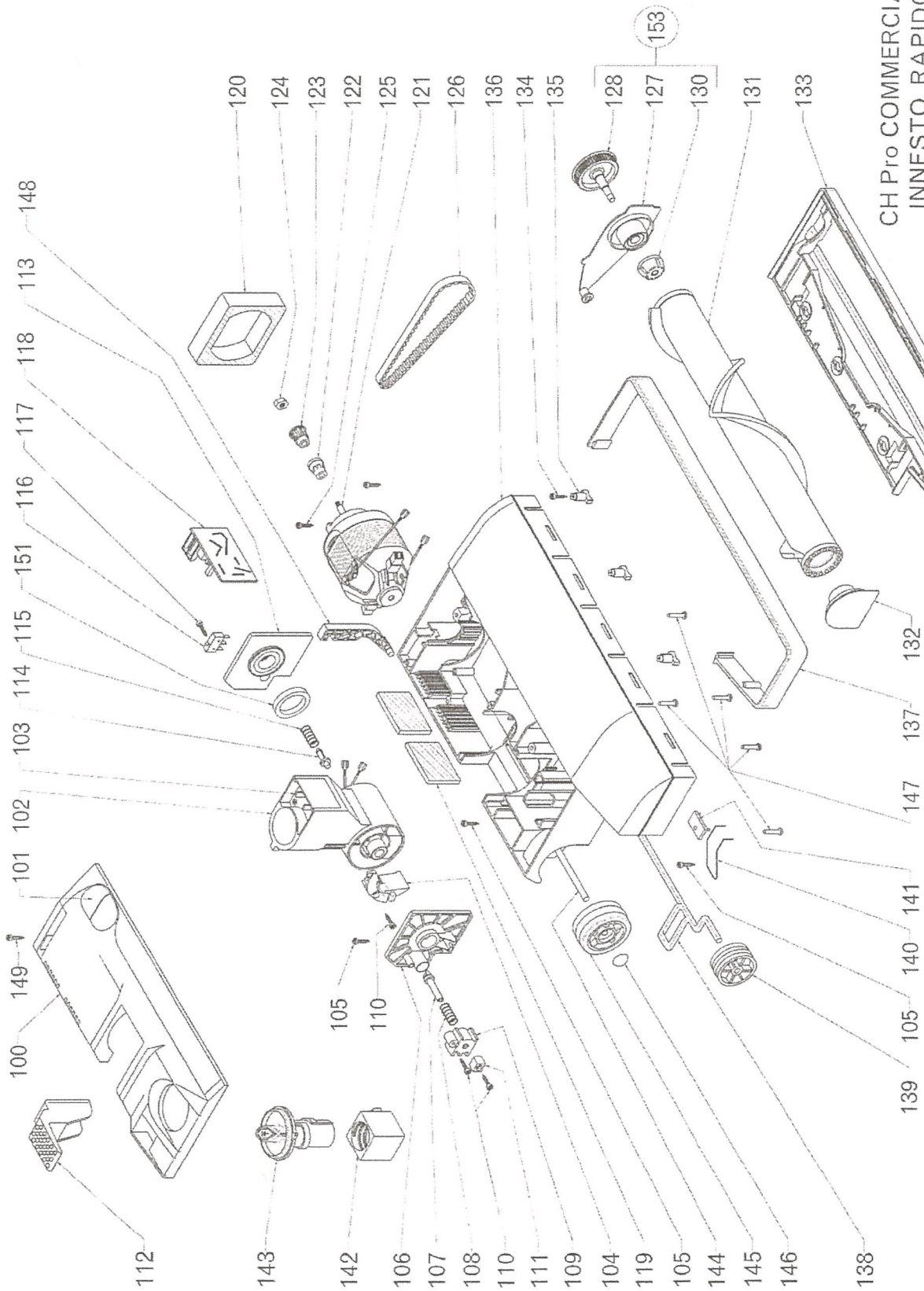

CH Pro COMMERCIAL
 INNESTO RAPIDO
LINDHAUS[®]
 QUALITY CLEANING EQUIPMENT





VIA BELGIO, 22 Z.I. - 35127 PADOVA - ITALY

Ph. +39 049 8700307 - Fax +39 049 8700605

e-mail: vacuum@lindhaus.it - www.lindhaus.it

Cod.Fiscale - P.IVA - Reg.Imp.PD 02151740285

Capitale Sociale 46.800,00 i.v.

LINDHAUS U.S.A.

P.O. BOX 159 / 12941 EAGLE CREEK PARKWAY
SAVAGE, MN 55378

www.lindhaususa.com

www.lindhaus.net

info@lindhaus.com

1-800-498-7526 / 952-707-1131

FAX: 952-707-1134

PARTS LIST

EFFECTIVE FROM

DATE

PAGE

1/2

CH PRO ECO FORCE - POWER BRUSH 12"(300) / 14"(380)

MODEL: 031208 (CHPRO 12") / 031408 (CHPRO 14")

Pos	Part Number	Description
100_	,084014681	BASE HOUSING COVER
100A_	,085150081	THROAT COVER WITH SPRING / FELT STRIP
100B_	,011000017	THROAT COVER FELT STRIP [ONLY]
101	,083950081	LENS SET RED AND GREEN
102	,084180380	JOINT COMPLETE
103	,082490080	MALE ELECTRICAL CONNECTION SET, 3 PRONG
104	,003820005	JOINT PIN SLIDE
105	085590009A	SCREW 3.9x13 (SINGLE)
106	080430381	SUPPORT RIGHT JOINT
107	000840036	PLUNGER HANDLE RELEASE
108	010390009	SPRING DOWEL RELEASE
109	000650036	BUSHING
110	085610009A	SCREW 2.9x16 (SINGLE)
111	000970305	SLIDE
112	,001923805	FOOT PEDAL BLUE
113	080440381	SUPPORT LEFT JOINT
114	000670036	SWITCH ACTIVATOR PIN
115	010480009	SPRING SWITCH ACTIVATOR PIN
116	020640000	MICROSWITCH
117	086950009A	SCREW 2.2x16 (SINGLE)
118_	,020610000	CIRCUIT BOARD M30 (12")
118_	020370000	CIRCUIT BOARD M38 (14") 100/120V W.170
119	010720316	EXHAUST FILTER
120	010580016	FILTER BRUSH MOTOR
121_	050030080	BRUSH MOTOR 100/120V (12"-14")
121A_	021260000	CARBON BRUSH FOR BRUSH MOTOR R73 (SET OF TWO)
121B_	,015210009	NUT M5, BRUSH MOTOR
122	002890029	METAL SPACER
123	002880029	METAL PULLEY
124	180160009A	NUT M4 (SINGLE)
125	085560009A	SCREW 3.9x16 (SINGLE)
126	010790300	TIMING BELT 7mm
127	181570029	TRANSMISSION SUPPORT WITH BEARINGS
128	060290081	PULLEY WITH SHAFT
130	088620081	DRIVE JOINT BASE

131_	,009590301	BRUSH ROLLER M30 (12") 1 BRISTLE 0,25 BLACK + INSERT
131_	009610301	BRUSH ROLLER M30 (12") 2 BRISTLE 0,25 BLACK + INSERT
131_	100110101	BRUSH ROLLER M30 (12") 1 BRISTLE WHITE (SOFT BRISTLE) + INSERT
131_	,009600301	BRUSH ROLLER M30 (12") 1 BRISTLE RED (STIFF BRISTLE) + INSERT
131_	009630301	BRUSH ROLLER M38 (14") 1 BRISTLE 0,25 BLACK + INSERT [STANDARD]
131_	,009620301	BRUSH ROLLER M38 (14") 1 BRISTLE WHITE (SOFT BRISTLE) + INSERT
131_	,009640301	BRUSH ROLLER M38 (14") 1 BRISTLE RED (STIFF BRISTLE) + INSERT
131A_	,100370004	INSERT, WHITE (MODIFY BRUSH ROLL TO ECO FORCE)
132_	181670029	ROLLER SUPPORT M30 (12")
132_	181580029	ROLLER SUPPORT M38 (14")
133_	005860333	BRUSH SHOE PLATE M30 (12")
133_	005870333	BRUSH SHOE PLATE M38 (14")
134	085540009A	SCREW 3.5x9.5 TG (SINGLE)
135	087491381A	ROLLER COVER CLIP (SINGLE)
136_	,087564681	BASE HOUSING M30 (12")
136_	181664681	BASE HOUSING M38 (14")
137_	,000603812	BUMPER M30 (12") BLUE
137_	,000593812	BUMPER M38 (14") BLUE
138	011320029	FRONT AXLE
139	002260000	FRONT WHEEL RUBBER
140	010430009	SPRING (AXLE)
141	000680036	SPRING STOP PLATE
142	000990305	BRUSH HEIGHT ADJUSTER
143	,003753804	ADJUSTING KNOB BLUE
144	011380009	REAR AXLE
145	002270000	REAR BIG WHEEL RUBBER
146	012840009	WHEEL RETAINER CAP
147	086440009A	SCREW 3.5x19 (SINGLE)
148	,001580304	SIDE LEVER
149	,087470009A	SCREW 3.9x13 TSP+ (SINGLE)
151	010980017	FELT RING
153	181590029	TRANSMISSION SUPPORT COMPLETE
	,003243001	DCS (DEEP CLEANING SYSTEM) CONVERTER
PBR	190614680	CH PRO M30-PB 12" POWER BRUSH REPLACEMENT ECO FORCE [COMPLETE]
PBR	190624680	CH PRO M38-PB 14" POWER BRUSH REPLACEMENT ECO FORCE [COMPLETE]

ENCAPSULATION IS LOW MOISTURE CARPET CLEANING METHOD / USE VACUUM WITH DCS CONVERTER

CHE-7000	PURE POWER / OXY-GEN - 12 QUARTS (ENCAPSULATION CARPET CLEANER)
MIS-7200	2 LITER – ALL ANGLE SPRAYER BOTTLE (DILUTE / APPLY CLEANERS)